

TIMKEN**The Timken Company**

4500 Mt Pleasant St. NW

N. Canton, OH 44720

Phone: (234) 262-3000**E-Mail:** CustomerCAD@timken.com • **Web site:** www.timken.com**Part Number 7200 BTN1, Timken® Single Row Angular Contact Ball Bearings (7200, 7300)**

Timken® angular contact ball bearings are designed for combination radial and axial loading. Single-row bearings have high thrust capacity in one direction. Some single-row bearings are specifically designed for duplex mounting in sets for maximum performance.

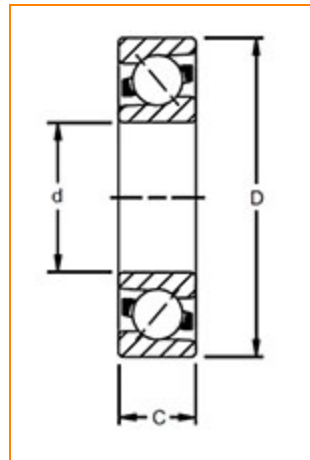

[Dimensions](#) | [Basic Load Ratings](#) | [Factors](#) | [Specifications](#) | [Abutment and Fillet Dimensions](#)

Dimensions

d - Bore	10.00 mm 0.3937 in
D - Outer Diameter	30.000 mm 1.1811 in
Bearing Width	9.000 mm 0.3543 in
Contact Angle	40 °

Basic Load Ratings

C0 - Static Radial Rating	2580 N 580 lbf
----------------------------------	-------------------



5450 N

C1 ISO - Dynamic Radial Rating	3050 N 1270 lbf
--------------------------------	--------------------

Factors

Limiting Speed (Grease)	24000 rpm
Limiting Speed (Oil)	32000 rpm

Specifications

Ball Type	STEEL
Cage Type	Molded
Cage Material	Polyamide
Bearing Weight	0.029 Kg 0.064 lb
Design Units	METRIC
R - Inner Ring "Touch" Radius	0.6
r - Outer Ring "Touch" Radius	0.6
Features	Open

Abutment and Fillet Dimensions

R - Inner Ring "To Clear" Radius ¹	0.30 mm 0.012 in
r - Outer Ring "To Clear" Radius ²	0.30 mm 0.012 in
da - Inner Ring Backing Diameter	15.0 mm 0.591 in
Da - Outer Ring Backing Diameter	25.0 mm 0.984 in

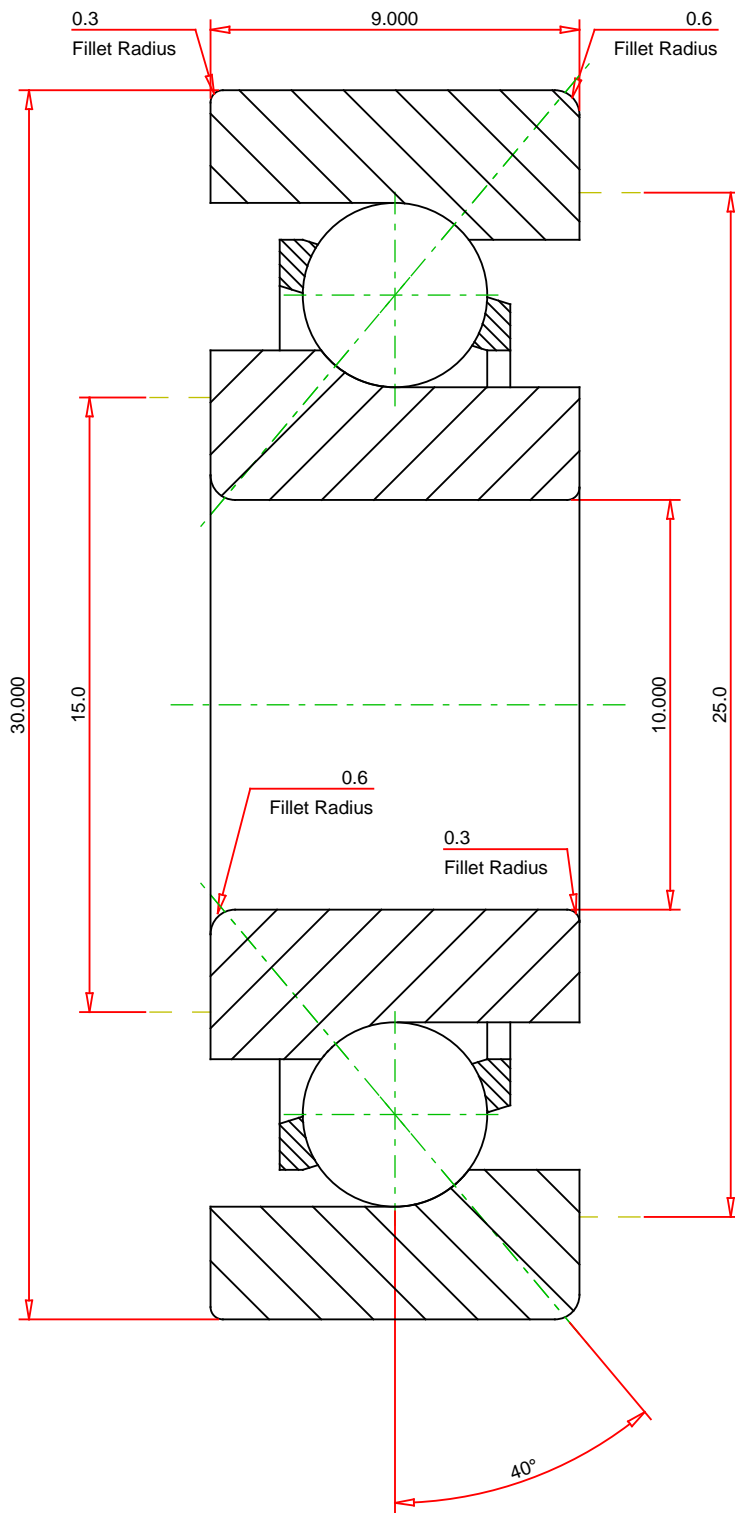

METRIC UNITS

Number of Balls Per Row 8
 Bearing Weight 0.029 kg

TIMKEN®

7200 BTN1
 Timken® Single Row Angular Contact Ball Bearings
 (7200, 7300)

THE TIMKEN COMPANY
 NORTH CANTON, OHIO USA

Dynamic Radial Rating 5650 N
 Static Radial Rating 2580 N

Every reasonable effort has been made to ensure the accuracy of the information contained in this writing, but no liability is accepted for errors, omissions or for any other reason.

FOR DISCUSSION ONLY